

Mécanique



KENT KGS 1532D

Machine occasion N° de stock : **A3472-1**



Année

2006

Course longitudinale

3200 mm

Course transversale	1700 mm
Course verticale	700 mm
Surface de la table	3200x1500 mm
Dimensions de la meule	500x120x203,2 mm
Nombre de postes sur tourelle 1	5000 à 30000
Moteur de broche	32 KW
Dimensions	11030x6075x4450 mm
Poids	32400 Kg

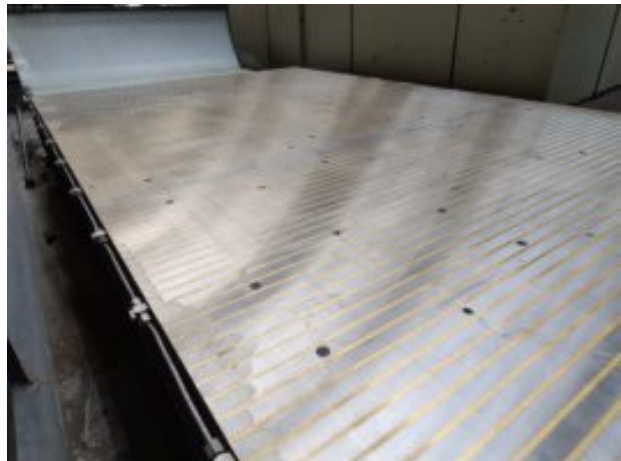

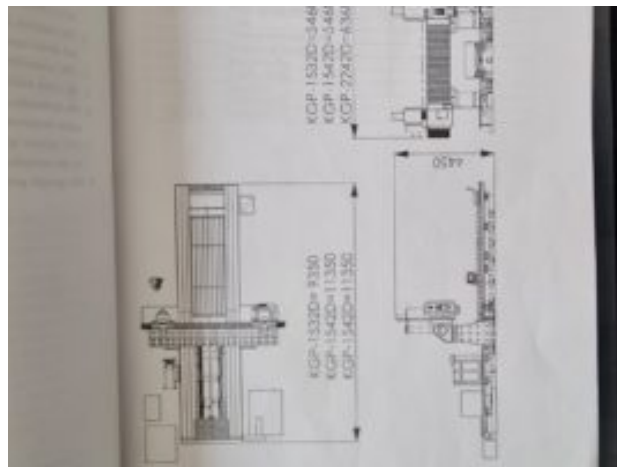
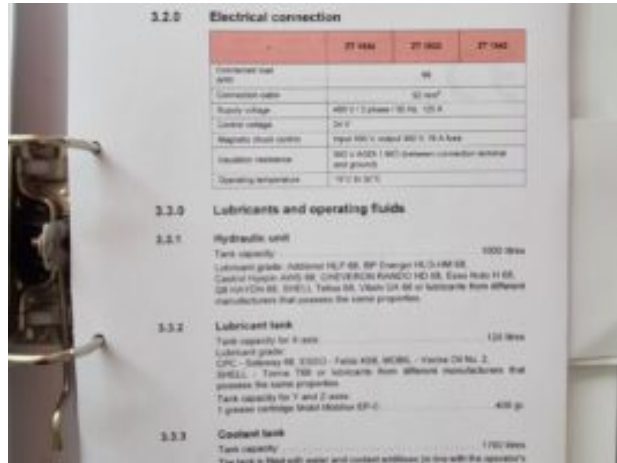



3.1.0 Machine data

	2T 1604	2T 1632	2T 1660
Spindling wheel (mm)	2400 x 1800	2200 x 1800	4200 x 1800
Reference height (mm)	1800		
Length of bed (mm)	2000	2000	4000
Distance from table to middle of spindle (mm)	1100		
Clearance between the table and the spindle (mm)	2000		
Magentic chuck dimensions (mm)	2400 x 1800	2200 x 1800	4200 x 1800
Table load (incl. integral top)	6000	8000	
Continuous feed longitudinal axis (mm/min)	5000 to 50000		
Continuous feed transverse axis (mm/min)	2000		
Continuous feed longitudinal axis (mm/min)	2000		
Spindling wheel dimensions (mm)	300 x 1000 x 300.5		
Spindling spindle motor output (kW)	30		
Control range of the spindling spindle motor (%)	1000 to 20000		
Machine weight (kg)	90000	100000	420000
Spindle requirement (mm)	6000	11000	19000
Spindle requirement (mm) width	9000		
Spindle requirement (mm) height	4400		



