

Mechanica



KENT KGS 1532D

Machine occasion N° de stock : **A3472-1**



Jaar

2006

verschuiving draai tafel

3200 mm

| | |
|----------------------|---------------------|
| Dwarsverplaatsing | 1700 mm |
| Verticale slag | 700 mm |
| Tafelafmeting | 3200x1500 mm |
| Slijp steen afmeting | 500x120x203,2 mm |
| Voedingsnelheid | 5000 à 30000 cps/mn |
| Spindel motor | 32 KW |
| Formaten | 11030x6075x4450 mm |
| Gewicht | 32400 Kg |





3.2.0 Electrical connection

| | ZT 1544 | ZT 1543 | ZT 1542 |
|-----------------------|---------|--|---------|
| Connection code | | 98 | |
| Connection ratio | | 63 mm ² | |
| Supply voltage | | 400 V 3 phase - 50 Hz - 3N+X | |
| Control voltage | | 24 V 0 | |
| Magnetic flux density | | 1000 mm ² - 1000 mm ² - 10 A/mm ² | |
| Insulation resistance | | 500 MΩ (1 MΩ between connection terminal and ground) | |
| Operating temperature | | -10 °C to 50 °C | |

3.3.0 Lubricants and operating fluids

3.3.1 Hydraulic unit

Tank capacity: 1000 litres

Lubricant grade: ADDONEL HLP 68, 68P Energol HLP 68-68 AW
 Control Hydraul AVIS 68, CHEVERON RANDEX HD 68, Exxon Mobil H 68, GE NUTROL 68, SHELL Tellus 68, Mobil DTE 68 or lubricants from different manufacturers that possess the same properties.

3.3.2 Lubricant tank

Tank capacity for 8 axes: 120 litres

Lubricant grade: CFC - Solimex 68, EXXON - FALCO 68, MOBIL - HYDRA 68 No. 2, SHELL - Torex 700 or lubricants from different manufacturers that possess the same properties.

Tank capacity for 7 and 2 axes: 400 litres

3.3.3 Coolant tank

Tank capacity: 1700 litres

The tank is filled with water and coolant solution in the ratio of the supplier's instructions.

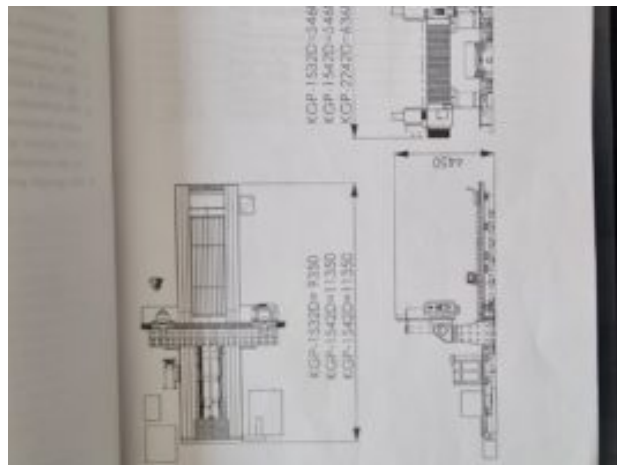



3.1.0 Machine data

| | 2T 1604 | 2T 1632 | 2T 1662 |
|--|--------------------|-------------|-------------|
| Spindling wheel (mm) | 2400 x 1500 | 2200 x 1600 | 4200 x 1500 |
| Reference height (mm) | 1500 | | |
| Length of bed (mm) | 2000 | 2000 | 4000 |
| Distance from table to middle of spindle (mm) | 1100 | | |
| Clearance between the table and the spindle (mm) | 2000 | | |
| Magnetic chuck dimensions (mm) | 2400 x 1500 | 2200 x 1600 | 4200 x 1500 |
| Table load (t) - integral top | 6000 | 8000 | |
| Continuous feed - longitudinal axis (mm/min) | 5000 to 50000 | | |
| Continuous feed - latitudinal axis (mm/min) | 2000 | | |
| Continuous feed - longitudinal axis (mm/min) | 2000 | | |
| Spindling wheel dimensions (mm) | 300 x 1000 x 300.5 | | |
| Spindling spindle motor output (kW) | 30 | | |
| Control range of the grinding spindle motor (%) | 1000 to 20000 | | |
| Machine weight (kg) | 90000 | 100000 | 420000 |
| Spindle requirement (mm) | 6000 | 11000 | 19000 |
| Spindle requirement (mm) - work | 9000 | | |
| Spindle requirement (mm) - height | 4400 | | |



