

Mecánica



## KENT KGS 1532D

Machine occasion    N° de stock : **A3472-1**



Año

2006

Carrera longitudinal

3200 mm

Carrera transversal	1700 mm
Recorrido vertical	700 mm
Superficie de la mesa	3200x1500 mm
Dimensiones de la muela	500x120x203,2 mm
Avance de trabajo	5000 à 30000 mm/mn
Motor de husillo	32 KW
Dimensiones	11030x6075x4450 mm
Peso	32400 Kg

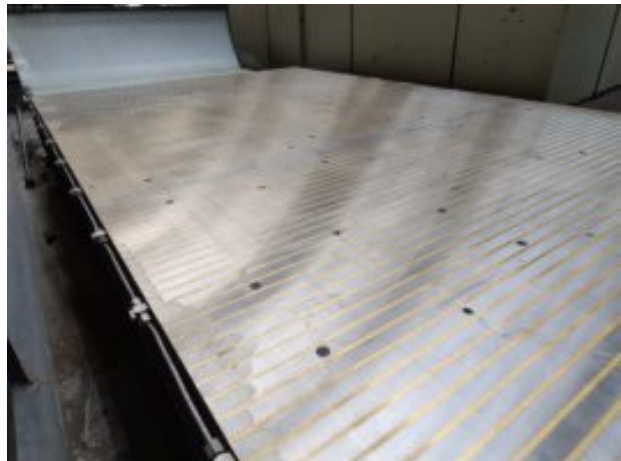



**3.2.0 Electrical connection**

	ZT 1544	ZT 1543	ZT 1542
Connection code		98	
Connection ratio		63 mm <sup>2</sup>	
Supply voltage		400 V 3 phase - 50 Hz - 3N+X	
Control voltage		24 V 0	
Magnetic flux density		1000 mm <sup>2</sup> in total 200 V 10 A max	
Insulation resistance		500 MΩ (500 V) between connection terminal and ground	
Operating temperature		-10 °C to 50 °C	

**3.3.0 Lubricants and operating fluids**

**3.3.1 Hydraulic unit**

Tank capacity: 1000 litres

Lubricant grade: ADDONEL HLP 68, 68P Energol HLP 68-68 AW  
 Castrol Hyslip AW 68, CHEVRON RIVOLTO HD 68, Esso Nuto H 68, GF HYFDM 68, SHELL Tellus 68, Mobil DTE 68 or lubricants from different manufacturers that possess the same properties.

**3.3.2 Lubricant tank**

Tank capacity for 8 axes: 120 litres

Lubricant grade: CPC - Solimex 68, EXXON - Falso 68, MOBIL - Vyrota 68 No. 2, SHELL - Turbia 700 or lubricants from different manufacturers that possess the same properties.

Tank capacity for 7 and 2 axes: 400 litres

1 grease cartridge brand Mobilux GP-C.

**3.3.3 Coolant tank**

Tank capacity: 1700 litres

The tank is filled with water and coolant solution in the ratio the operator's.

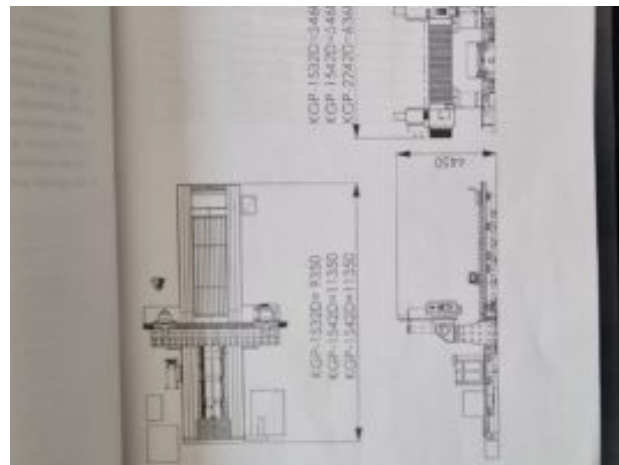



3.1.0 Machine data

	2T 1604	2T 1632	2T 1660
Working area (mm)	2400 x 1800	2200 x 1800	4200 x 1800
Reference height (mm)	1800		
Length of bed (mm)	2000	2000	4000
Distance from table to middle of spindle (mm)	1100		
Clearance between the lathe and the table (mm)	2000		
Magnetic chuck dimensions (mm)	2400 x 1800	2200 x 1800	4200 x 1800
Table load (t) - integral top	6000	8000	
Continuous feed - longitudinal axis (mm/min)	5000 to 50000		
Continuous feed - lathe axis (mm/min)	2000		
Continuous feed - longitudinal axis (mm/min)	2000		
Working wheel diameter (mm)	300 (1000 x 300.5)		
Working spindle motor output (kW)	30		
Control range of the grinding spindle motor (%)	1000 to 20000		
Machine weight (kg)	90000	100000	420000
Spindle requirement (mm)	6000	11000	19000
Spindle requirement (mm) - work	9000		
Spindle requirement (mm) - height	4400		



